



# NEWSLINE

June 2019

In this Issue: CEO Report pg 2 • Summer tips pg 3 • Lunch on the Farm pg 4

## REA Mourns the Loss of a Friend and a Director **STEVE PEDERSON**

We are sad to announce that Steve Pederson, age 50, of Farwell, died on May 25, 2019, at St. Mary's Hospital in Rochester, MN, after a 4-year battle with cancer.

Steve has served on the REA Board of Directors since 2014 representing District 7. "Steve was a great asset to the Board of Directors and the membership," said REA CEO Kristin Dolan. "Steve was a person of high integrity and worked hard to benefit those around him. He did his research, was very engaged and asked insightful questions. He presented pertinent information to the REA Board of Directors following meetings he attended, such as his STAR Director position on the STAR Board."

Steve represented REA on the STAR Energy Services Board of Governors since 2015. Located in Alexandria, STAR is a subsidiary of REA.

"Steve was a true asset to the board of directors, always coming prepared and asking questions that helped all of us," comments REA Board President Barbara Johnson. "He truly served his district well. Additionally, he was a fine man and one I was truly blessed to work with. He will be missed by all of us on the board, both as a board member and as a friend."

Steve leaves behind his wife, JoAnn, daughter, Valencia, son, AJ., and many other family members in the Farwell area. "Steve made the world around him better with all of his contributions. He will be dearly missed by us all!" said Dolan.



**Steve Pederson 1969 - 2019**



**Audrey Hjelle congratulates Steve on achieving the NRECA Credentialed Cooperative Director Certificate (11/2015)**



**JoAnn and Steve at the Garrison Dam while on the 2014 Coal Creek Tour**



**Steve, JoAnn, AJ and Valencia at the 2015 REA Pancake Feed**



CEO, Kristin Dolan

# A Note from the CEO: REA Partnerships - Stories of Success

Kristin Dolan, CEO, Runestone Electric Association

For more than twenty years, REA has owned two other services companies in partnership with several Minnesota and Iowa electric distribution cooperatives. Through these partnerships, we can offer additional services to you our members and to also secure and share needed resources, saving on costs. The two companies we own are Heartland Security and STAR Energy Services.

## Heartland Security

Heartland Security provides home and business security services and monitoring in our Midwest region and is celebrating its 20th anniversary this year. In 1999 Heartland Security was founded by nine electric cooperatives and has expanded to thirteen owners today. Heartland has experienced tremendous growth over the last twenty years and continues to be a valuable service offering for REA and our member-owners.

Heartland Security offers several security services including home security, business security, ag monitoring (typically for hog barns), medical alerts, camera systems, card access, and panic buttons. Heartland Security also offers environmental sensors to protect your home or business from water, carbon monoxide, smoke, extreme temperatures, and freezing pipes. In addition, Heartland Security can upgrade you to a doorbell camera where you can answer the door from your smartphone, even if you're not home.

Since Heartland Security began in 1999, it has continued to upgrade its technologies to offer customers the most reliable products and services to keep up with the market. At this point a Heartland Security system can serve as the hub to your smart home, helping you control your thermostat, lights, locks, garage doors, and cameras — all from one app on your smartphone or tablet. Their alarm systems integrate with Amazon's Alexa, Google's Home, and Apple smartwatches. You can add almost any kind of Z-wave device into your system from smart outlets to motorized window coverings.

According to Guy Adams, Heartland Security's General Manag-

er, "Heartland Security takes pride in providing the best service possible to our customers." Heartland Security has top-notch technicians, a knowledgeable sales team, and caring office staff. All of Heartland Security's employees have biannual background checks, and thousands of customers have trusted them to help protect what matter most.



Heartland Security's biggest referral source is word-of-mouth. If you recommend Heartland Security to someone and they purchase a new security system, you will receive \$40 cash or a \$40 credit on your Heartland Security account. Members of REA who purchase a new security system receive a 10% discount on the base package and \$1 off the regular monthly security monitoring rate.

Heartland Security offers a free security analysis to anyone interested in their offerings. A sales representative will come to your location for a free, no-obligation visit to create a customized security solution. For more information about Heartland Security or a free security analysis, call 888-264-6380 or visit them online at [www.heartlandss.com](http://www.heartlandss.com).

## STAR Energy Services

STAR Energy Services was created to provide needed electrical engineering and services to electric distribution service providers like REA. STAR was formed in 1997 and is owned by seven electric distribution cooperatives. STAR serves our mapping, outage management, electric distribution plant planning, and design and preventative maintenance initiatives. STAR has been a valuable investment for REA, we have saved money through sharing needed resources, and most importantly, they help to deliver reliable energy to you our members. The most visible service our members see from STAR is the outage map available on our website. The map can be viewed by clicking on "Outage Center" at [www.RunestoneElectric.com](http://www.RunestoneElectric.com).

## Electrifying your everyday

Did you know that the cost to charge your cell phone for one year is just \$2.88? What amazing value electricity provides to power our every day. The employees at REA greatly enjoy serving you, our members, and are proud to provide this valued resource to you.

We are thinking of our area farmers as they work to get their crops in during this cold and wet spring. Please work safe and always pause to look around and up for power equipment and wires. We hope for much needed warm and dry weather soon for all of you.



**Charging your phone for a year**

**\$2.88**

Electricity continues to be a great value brought to you by Runestone Electric Association  
Based on REA's average kWh rate of 11.5¢

## REA Board of Director Meeting Highlights - March 2019

- » Mrs. Nelson reviewed the Financial Report for March 2019, noting strong energy sales with kWh sales 10% over budget. The YTD margin is ahead of budget with a higher gross margin, non-operating income gains and expenses are behind budget.
- » With approval of the Restated Articles of Incorporation, REA is now a non-stock membership organization. The par value of capital stock amounts held by the cooperative will be returned to members as a bill credit in the future. 2018 margins will be assigned to member accounts as capital credits in May (as noted on the bill you received this month).
- » Appointed Mandy Westrom, Barrett (District 3) and Rodger & Patty Mattson, Farwell (District 7) to the Member Advisory Council.
- » Selected Director Audrey Hjelle to serve as REA's representative on the Great River Energy Board of Directors.
- » Selected Director Steve Pederson to represent REA on the STAR Energy Services Board of Governors.

The regular June board meeting will be June 24, 2019.



# Don't Wait for a Disaster, Consider Installing a Generator

## 5 common reasons why people say they purchase standby generators:

**1** "Keeping our fridge and freezer running during a storm has saved us a lot of money and wasted food."

**2** "We travel often in the winter months and worry about the pipes freezing if the power is out and house has no heat; not the kind of surprise we want when we come home."

**3** "I often travel on business and need to know that if the power goes out, my family and home are safe and secure when I'm not there."

**4** "We have a well and without electricity we have no water - no drinking water, no flushable toilets and no showers."

**5** "I did not want to hassle with my tractor-driven PTO generator any more. I wanted a generator that would start automatically, whether I was home or not. I did not want my wife worrying about how to get the tractor started and hooked up if I was on the road."



There are many good reasons to install an automatic Briggs & Stratton generator that can power the entire house or farm. REA offers this turn-key installation and maintenance service.

Call REA for more information  
800-473-1722 or visit [www.runestoneelectric.com](http://www.runestoneelectric.com).



12KW



20KW

### Generator packages include the following:

- » Generator
- » DirectPower™ Automatic Transfer Switch
- » Basic installation
- » Cold weather kit and battery
- » Concrete pad
- » Remote indicator light
- » 12 months maintenance by REA

# Summer Home Check List

- 1. Make sure your AC or heat pump is ready for the summer heat by scheduling a tune-up with your HVAC contractor.** A tune-up can increase the operational efficiency of the unit and qualifies for a rebate of \$25 from REA.
- 2. Now is a good time to check that the thermostat on your in-floor heating and baseboard heating systems are turned off.** These silent heating systems can sometimes be forgotten and result in extra heating and cooling costs for your home if left running.
- 3. Summertime is a perfect time to give your air exchanger a rest.** Heat recovery ventilators (air exchangers) left running in the summer cause additional cooling load and additional cost to operate.
- 4. Dehumidifiers play an important role in removing moisture but can use \$30 - \$45 of electricity per month if run 24/7.** Replace your standard dehumidifier with an Energy Star® rated model the uses 10-20% less energy and receive a \$25 rebate from REA.

# Renewable Energy is Easier Than you May Think

Using renewable energy to power your home or business is easy with REA's Wellspring Wind Energy Program. Wellspring Wind Energy allows our members to ensure the energy they consume comes from a renewable source like the wind. You can purchase a kilowatt-hour (kWh) of wind power by adding .2¢ to REA's current electric rate. Wellspring can be purchased in blocks of 100 kWhs (20¢ for 100 kWh) for a portion or all of your energy needs.

The best part is that Wellspring provides members with a means of supporting renewable energy without the expense of installing generation equipment on their property.

For more information visit [www.runestoneelectric.com](http://www.runestoneelectric.com) or call REA at 800-473-1722.



Join Douglas County American Dairy Association for

# Douglas County LUNCH ON THE FARM

June 22 11 a.m. to 1 p.m.



## Douglas County Lunch on the Farm is back!

Join us for lunch at the Lund Family Farm, 14800 Century Rd NW, Brandon. Check out the animals and see a robotic dairy operation at work. Come for the FREE lunch and enjoy ice cream compliments of REA!

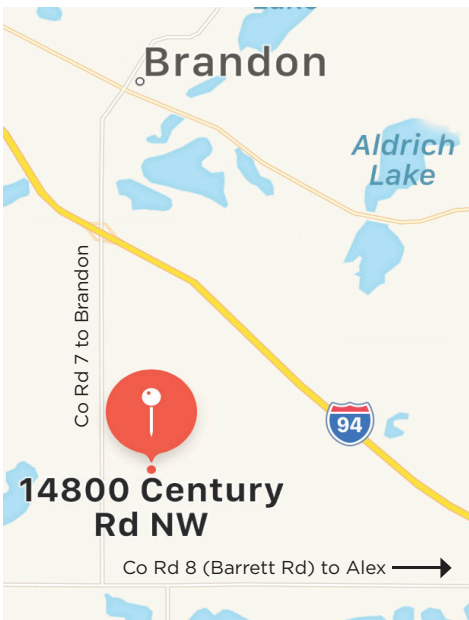

## REA Ford F-150 Pick-up For Sale



**2010 Ford F-150 4x4 Extended Cab.**  
138K Miles (New Motor at 103K)  
5.4L V8 A/T, Power Windows and Locks

Bids are now being accepted to sell a used pick-up truck. The truck may be viewed at REA's operation Center from 9:00 a.m. - 2:00 p.m., Monday - Friday until July 1, 2019. The equipment will be sold "as is" and "with all faults." REA's Purchase Agreement form will need to be signed by the buyer prior to closing. Cash payment required, no checks please. REA reserves the right to accept or reject any and all offers. Deadline for submitting a bid is July 1, 2019.

Please submit your bid to:  
**REA Pick-up Bid**  
6839 Power Lane SW  
Alexandria, MN 56308

## NEWSLINE

The Official Monthly publication of Runestone Electric Association.

6839 Power Lane SW  
Alexandria, MN 56308

320-762-1121  
Fax: 320-763-4149

rea@runestoneelectric.com

**24/7: 800-473-1722**

**Office Hours:**  
8 a.m. to 4:30 p.m. Mon- Fri.

**Memorial Day to Labor Day:**  
7:30 a.m. to 4 p.m. Mon- Fri.

### Board of Directors

- District 1: Barbara Johnson, President
- District 6: Clif Patrick, Vice President
- District 5: Mike Loken, Treasurer
- District 1: Gary (Andy) Anderson, Secretary
- District 3: Audrey Hjelle, Director
- District 7: Steve Pederson, Director
- District 4: Dave Staples, Director

### Editorial Staff

- Kristin Dolan, CEO
- Sue Lundeen, Editor

### In Case of a Power Outage

- » Please call 800-473-1722 for 24-hour service. Please report any tree branches in lines, twisted wires, broken poles and if your neighbors are also out of power.
- » Be sure to have a corded phone or a charged cell phone in the house, because cordless phones won't work when the power is out.
- » Program the number above your into your cell phone for easy access.
- » Never assume we know you are without power. Always call to report an outage.

**REA is an Equal Opportunity Provider**



## Know whats below. Call before you dig.

Call 811 or  
vist [gopherstateonecall.org](http://gopherstateonecall.org)  
before you dig.

